

Thermaltake Core X2 M-ATX Cube Case

- **Style : Gaming**

- **Size : Cube case supports up to M-ATX MB**

- **Material : Steel & Plastic**

- **Main Feature**

- **Connection : Side I/O ports including 2 USB 3.0**

- **Ventilation : 2 preinstalled 120mm fans with removable filters**

- **Expansion : 3+7 drive bays with modular drive racks design**



Thermaltake Core X2 M-ATX Cube Case

• Specification

Model	Core X2
P/N	CA-1D7-00C1WN-00
Case Type	M-ATX Cube Case
Chassis Dimension (H*W*D)	465 x 320 x 541 mm (18.3 x 12.6 x 21.3 inch)
Net Weight	11.6 kg / 25.6 lb
Side Panel	Transparent Window
Color	Exterior & Interior : Black
Material	SPCC
Cooling System	Front (intake) : 120 x 120 x 25 mm Turbo fan (1000rpm, 16dBA) Rear (exhaust) : 120 x 120 x 25 mm Turbo fan (1000rpm, 16dBA)
Drive Bays	3 x 5.25"
-Accessible	4 x 3.5" or 2.5" (HDD Cage)
-Hidden	3 x 2.5" (HDD Tray)
Expansion Slots	5
Motherboards	6.7" x 6.7" (Mini ITX), 9.6" x 9.6" (Micro ATX)
I/O Port	USB 3.0 x 2, HD Audio x 1
PSU	Standard PS2 PSU (optional)
LCS Upgradable	Supports 1/2" 、 3/8" 、 1/4" water tube
Fan Support	Front: 3 x 120mm 2 x 140mm 1 x 200mm Top: 6 x 120mm 2 x 140mm 2 x 200mm Rear: 1 x 120mm or 1 x 140mm Bottom: 2 x 120mm Left / Right Side: 3 x 120mm
Radiator Support	Front: 1 x 120mm or 1 x 240mm or 1 x 360mm 1 x 140mm or 1 x 280mm Top: 2 x 120mm or 2 x 240mm or 2 x 360mm 1 x 140mm or 1 x 280mm Rear: 1 x 120mm or or 1 x 140mm Bottom: 1 x 120mm or 1 x 240mm Left / Right Side: 1 x 120mm or 1 x 240mm or 1 x 360mm
Clearance	CPU cooler height limitation: 230mm VGA length limitation: 330mm(with ODD Cage) 480mm(without ODD Cage) PSU length limitation: 220mm (With Bottom Fan)

Thermaltake Core X2 M-ATX Cube Case

•Packaging

Package Information

EAN Code	4717964400239
UPC Code	841163060049
N.W	11.6 kg / 25.6 lb
G.W	13 kg / 28.7 lb
Carton Size (L x W x H)	607 x 384 x 513mm / 23.9 x 15.1 x 20.2 inch
Cuft	4.22
Container	w/o pallet
20'	228
40'	468
40' HQ	585



Thermaltake Core X2 M-ATX Cube Case

• Appearance



Angle view



Thermaltake Core X2 M-ATX Cube Case

• Appearance



Top view

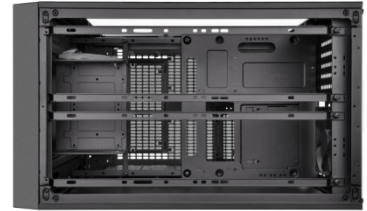

Top view (Without Top Panel)



Left Side view

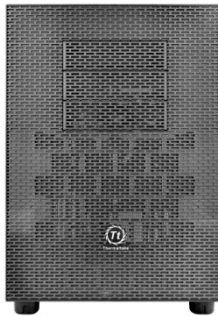

Front view



Right Side view



Left Side view (Without Side Panel)



Rear view



Right Side view (Without Side Panel)

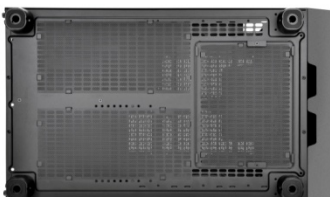

Bottom view

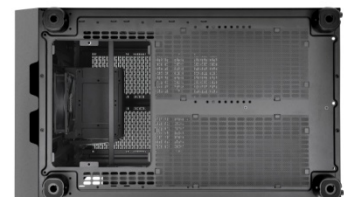

Bottom view(Without Bottom Panel)

Thermaltake Core X2 M-ATX Cube Case

• Unique Design



Maximum CPU cooler height up to 23cm



Maximum radiator support up to 36cm



Stackable & expandable for enthusiasts



Thermaltake Core X2 M-ATX Cube Case

- **Unique Design**



Full modular design



Interchangeable window & I/O panel

Thermaltake Core X2 M-ATX Cube Case

- **Structure (External)**



Side I/O ports with dual USB 3.0

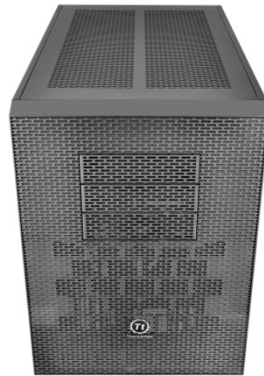

Metal Mesh front panel



Top magnetic fan filter



Side magnetic fan filter

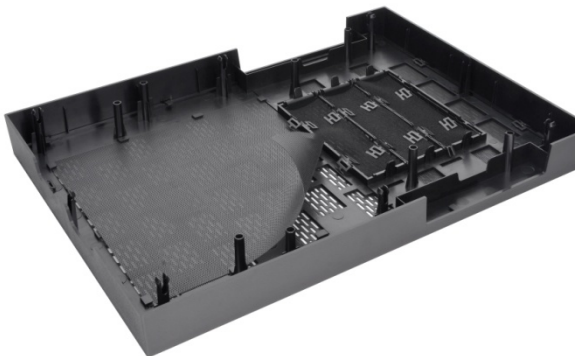

Front fan filter



Bottom filter

Thermaltake Core X2 M-ATX Cube Case

- **Ventilation**



Built-in front 12cm fan



Built-in rear 12cm fan

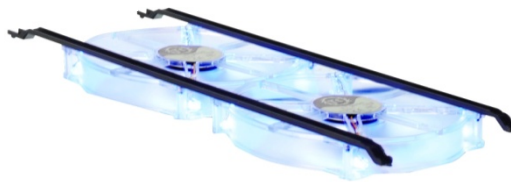
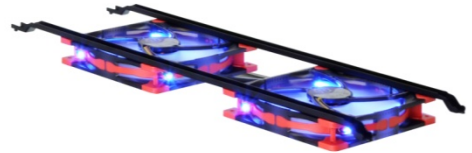
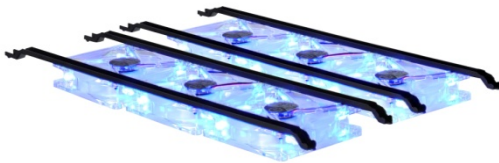

12 , 14 & 20 cm fan bracket on top

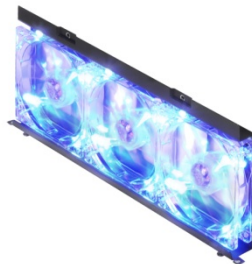

12 cm fan bracket on side

Thermaltake Core X2 M-ATX Cube Case

• Structure (Internal)

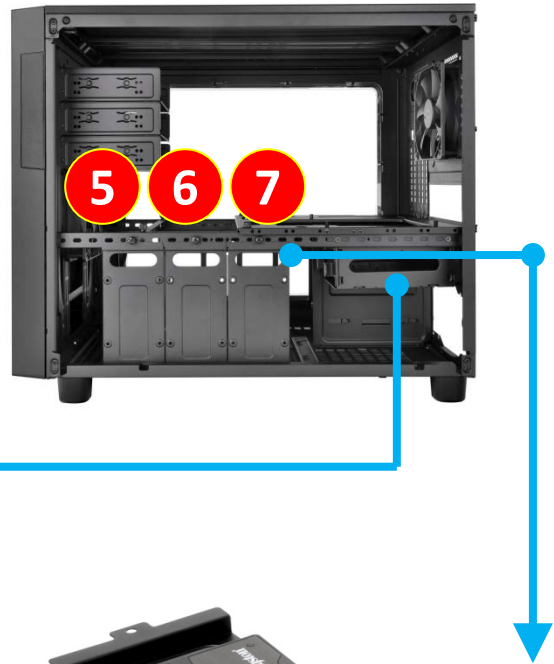
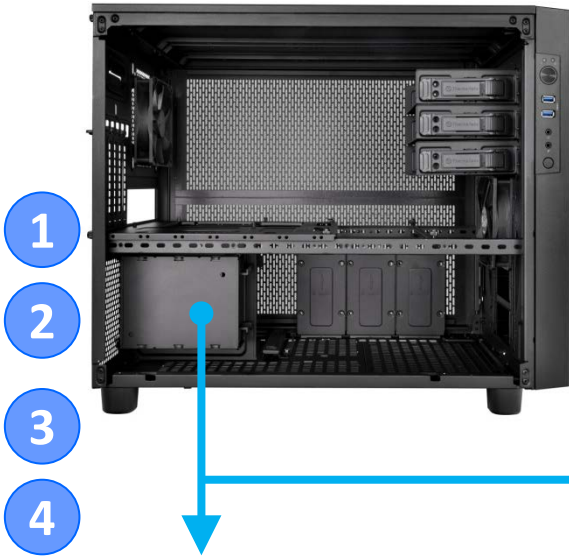

4 x 3.5" or 2.5" device

3 x 2.5" device

Thermaltake Core X2 M-ATX Cube Case

- Structure (Internal)



Maximum VGA length up to 48cm



Thermaltake Core X2 M-ATX Cube Case

• The Cooling System - Air Cooling

Pure
12

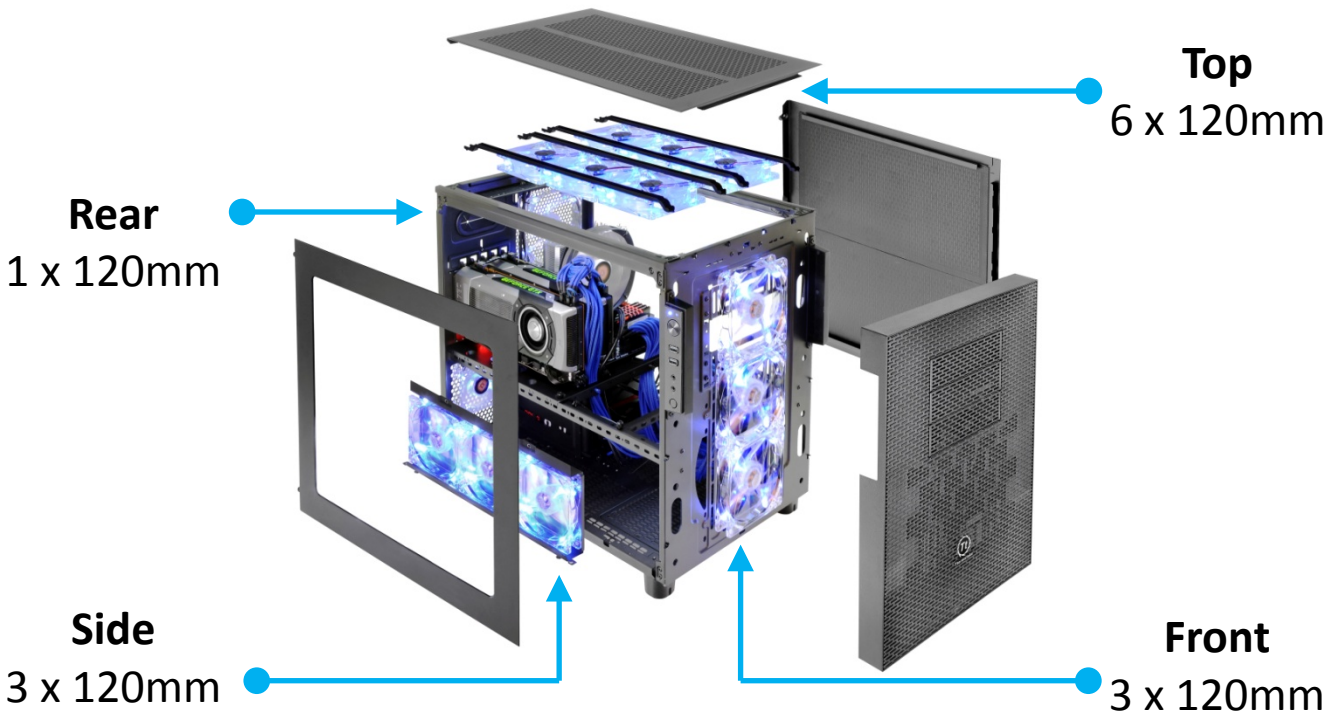
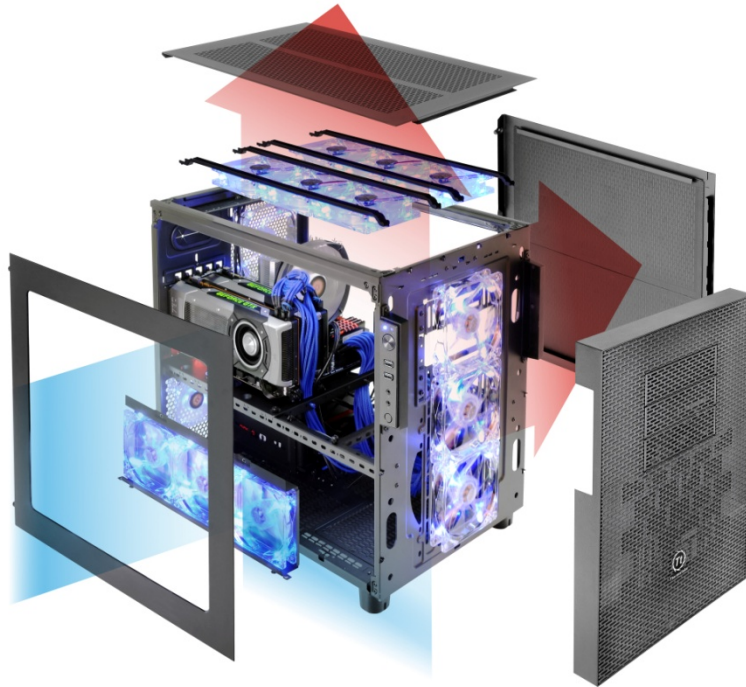
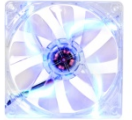

Thermaltake Core X2 M-ATX Cube Case

• The Cooling System - Air Cooling

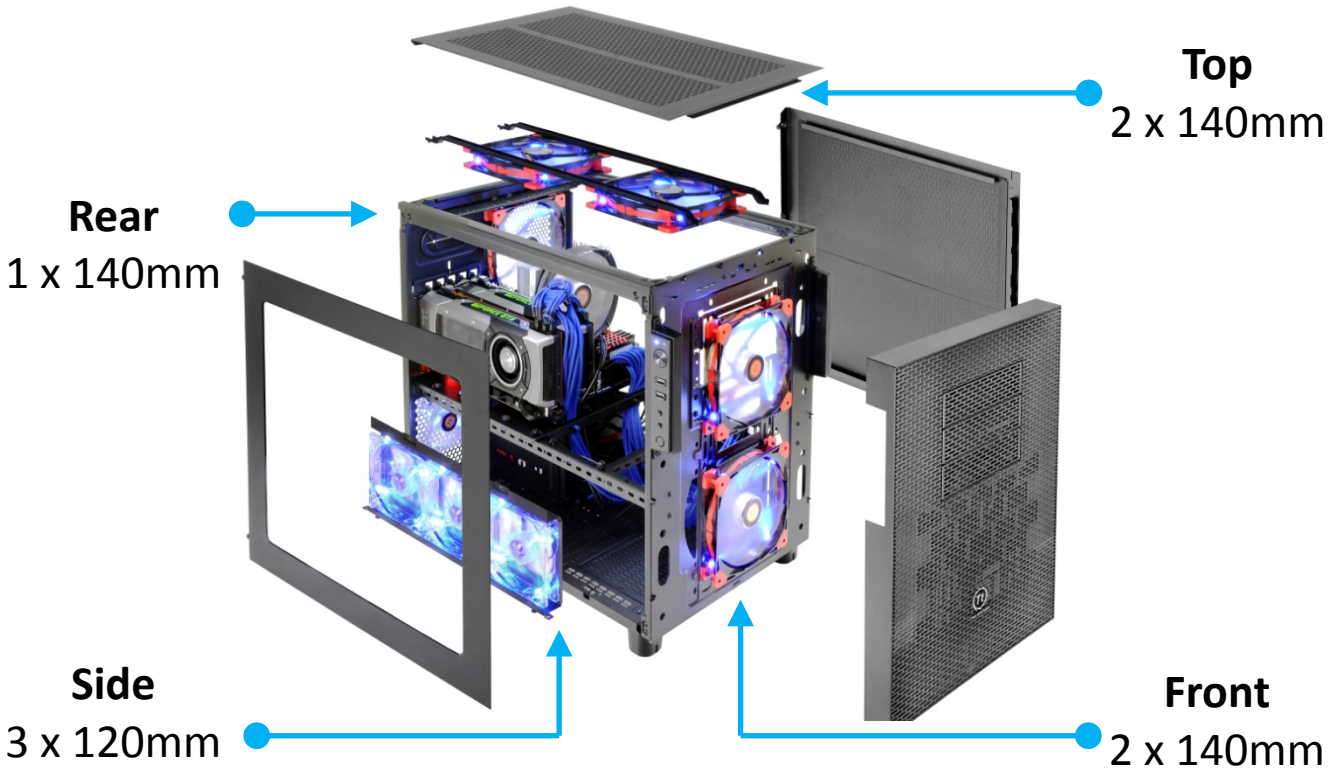
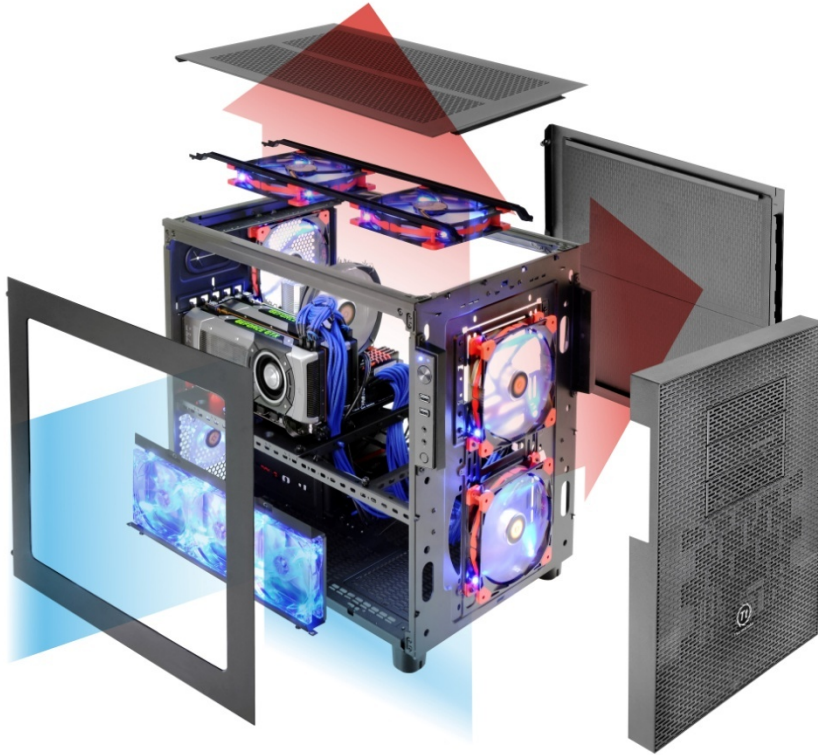

Thermaltake Core X2 M-ATX Cube Case

• The Cooling System - Air Cooling

Pure
20

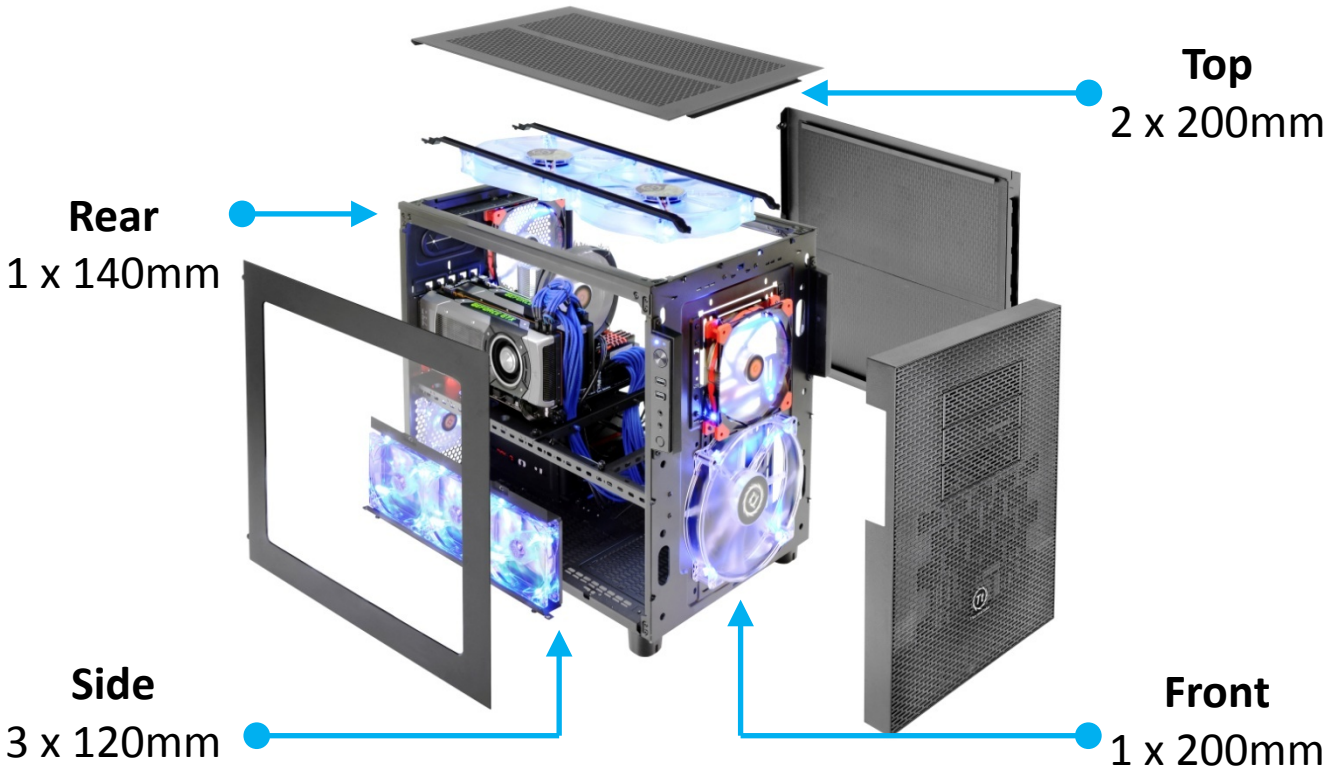
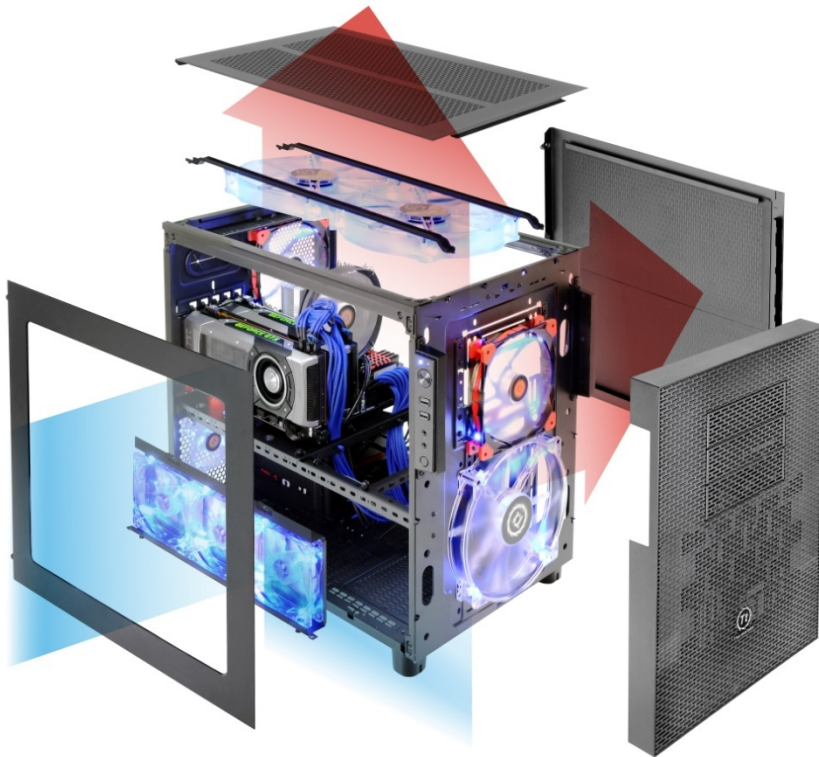

Thermaltake Core X2 M-ATX Cube Case

- The Cooling System – AIO Liquid Cooling (Optional)

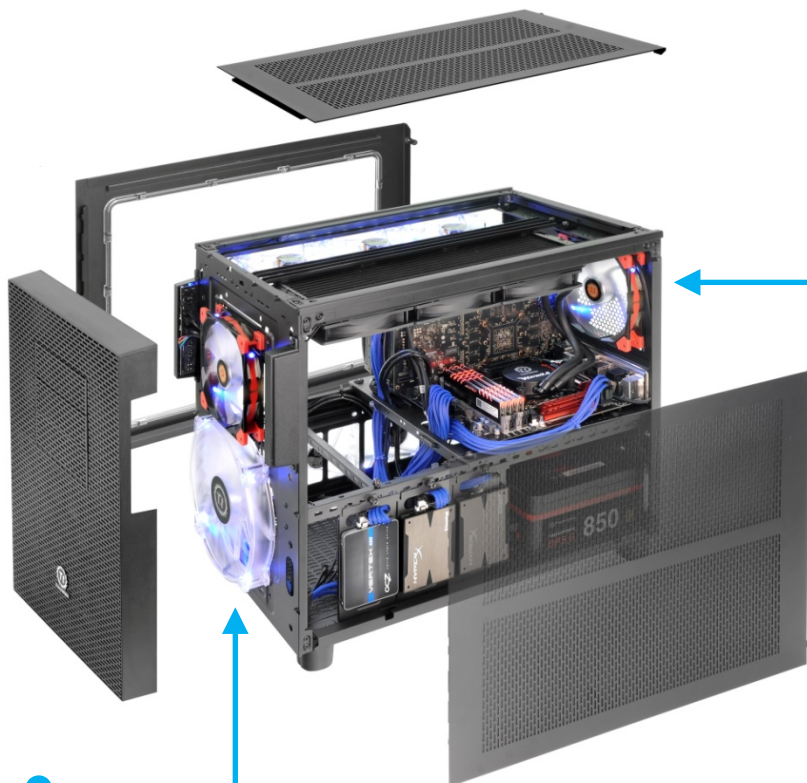
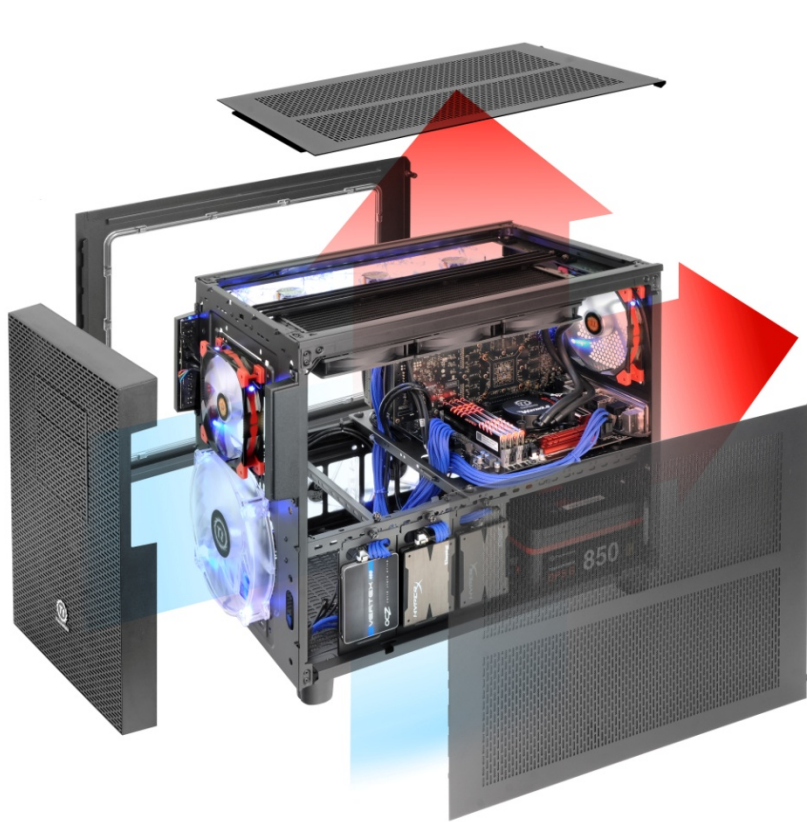

Rear
1 x 140mm

Front
1 x 200mm

Thermaltake Core X2 M-ATX Cube Case

- The Cooling System – DIY Liquid Cooling (Optional)

Pure
20



Rear
1 x 120mm

Front
1 x 200mm

Thermaltake Core X2 M-ATX Cube Case

• The Cooling System - Air Cooling

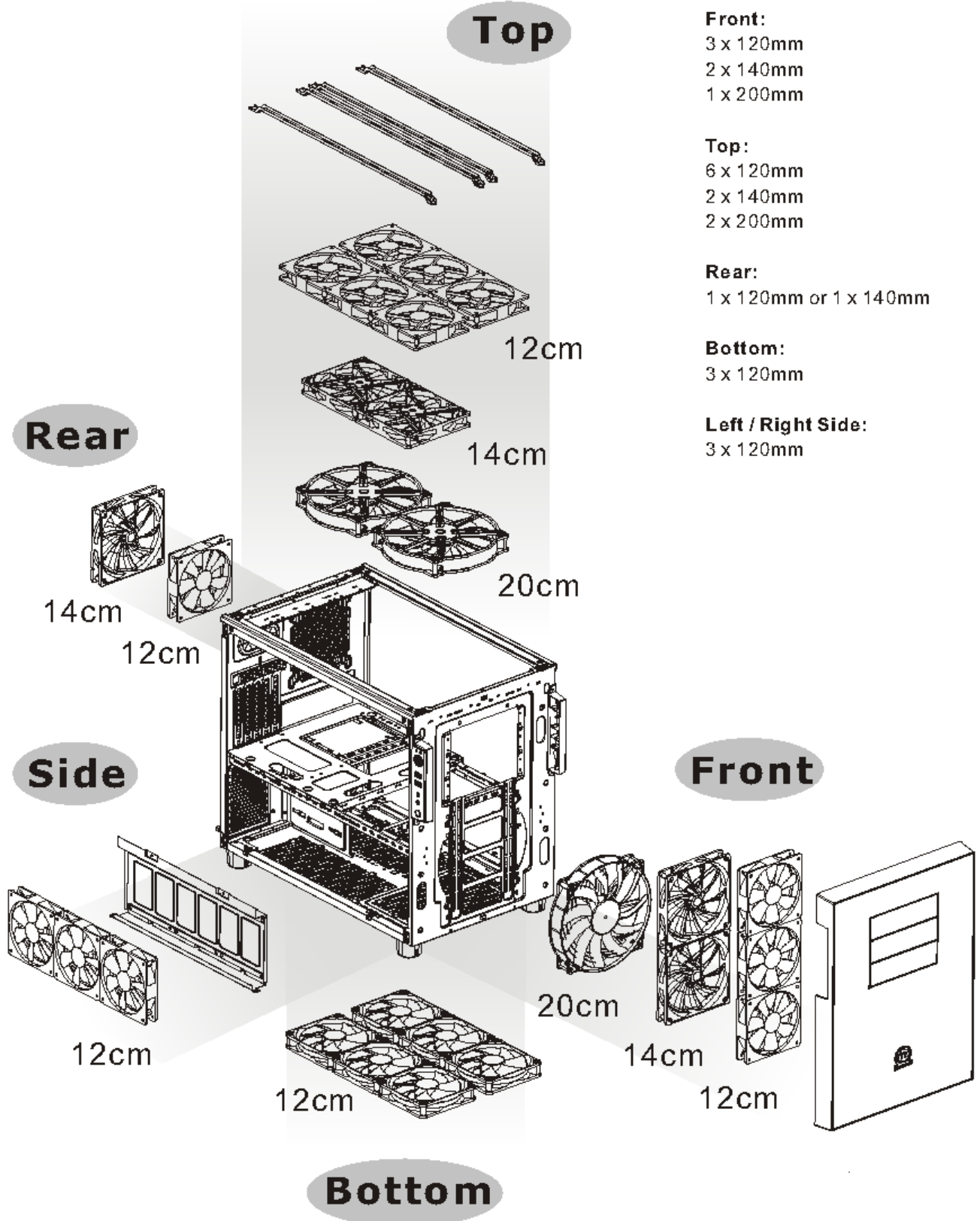

Thermaltake Core X2 M-ATX Cube Case

• The Cooling System – Liquid Cooling (Optional)

Top

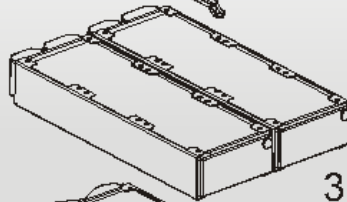
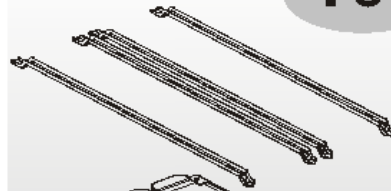

36cm

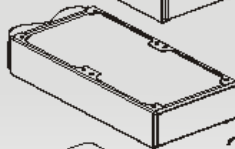

28cm

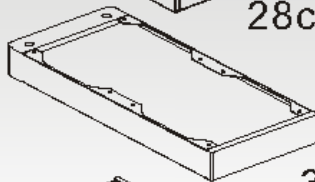

36cm

Front:

1 x 120mm or 1 x 240mm or 1 x 360mm
1 x 140mm or 1 x 280mm

Top:

2 x 120mm or 2 x 240mm or 2 x 360mm
1 x 140mm or 1 x 280mm

Rear:

1 x 120mm or 1 x 140mm

Bottom:

1 x 120mm or 1 x 240mm or 1 x 360mm

Left / Right Side:

1 x 120mm or 1 x 240mm or 1 x 360mm

Rear

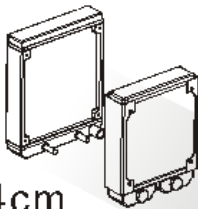

14cm

12cm

Side

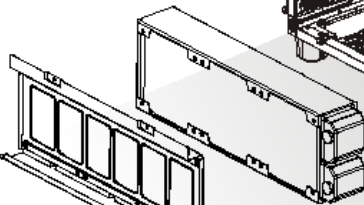

36cm

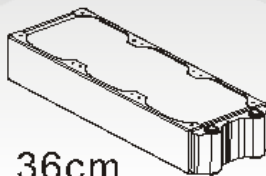

36cm

Front

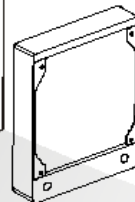

18cm



28cm



36cm

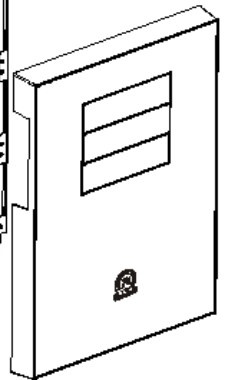

Bottom

Thermaltake Core X2 M-ATX Cube Case

• Compatibility List

Fan Compatibility List			
	12cm	14cm	20cm
Front	3	2	1
Top	6	2	2
Rear	1	1	-
Bottom	6	-	-
Side(L/R)	3	-	-

Thermaltake Compatible Fan			
	12cm	14cm	20cm
PURE FAN Series	●	●	●
LUNA FAN Series	●	●	●
Odin FAN Series	●	-	-

Thermaltake Core X2 M-ATX Cube Case

• Compatibility List

Radiator Compatibility List			
	12cm	24cm	36cm
Front	●	●	●
Top	●	●	●
Rear	●	-	-
Bottom	●	●	●
Side(L/R)	●	●	●

Radiator Compatibility List		
	14cm	28cm
Front	●	●
Top	●	●
Rear	●	-
Bottom	-	-
Side(L/R)	-	-

Radiator Compatibility List		
	18m	36cm
Front	●	-
Top	●	●

Water 3.0 Compatibility List				
	Performer	Pro	Extreme	Ultimate
Front	●	●	●	●
Top	●	●	●	●
Rear	●	●	●	-
Bottom	●	●	●	●
Side(L/R)	●	●	●	●

Thermaltake Core X2 M-ATX Cube Case

• Compatibility List

✘ Only on stacking mode

Radiator Compatibility List (Stacking Mode)

	48cm
Front	●

Radiator Compatibility List (Stacking Mode)

	42cm
Front	●

Radiator Compatibility List (Stacking Mode)

	36cm	54cm
Front	●	●